



153 Laleham Road

, Shepperton, TW17 0AH

**Asking price £439,950**

SALE AGREED BY NEWBOULDS & CO



Viewing

Please contact our Shepperton - Sales Office on 01932232927 if you wish to arrange a viewing appointment for this property or require further information.



4



1



1



## Floor Plan

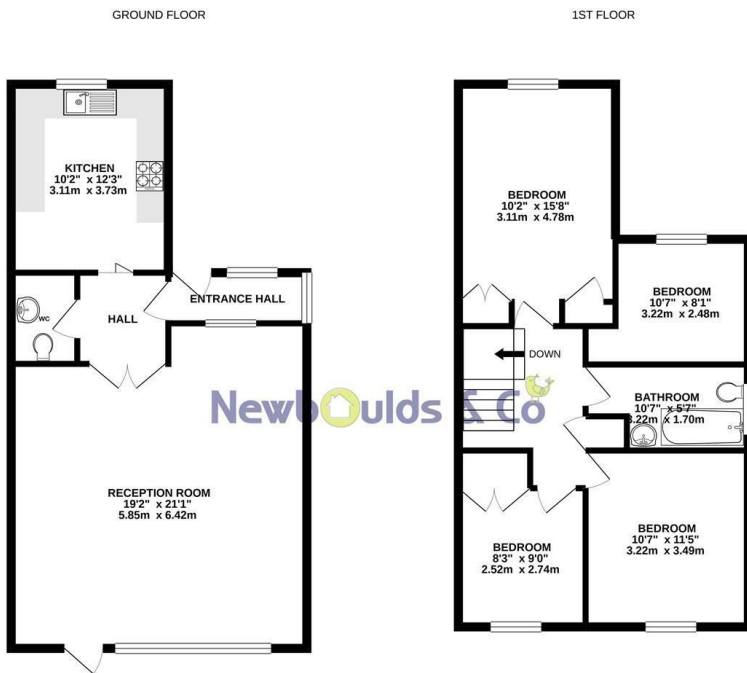

Newboulds & Co

TOTAL FLOOR AREA - 1227sq ft (114.0 sq m) approx.  
Whilst every attempt has been made to ensure the accuracy of the floorplan contained herein, measurements of doors, windows, rooms and any other items are approximate and no responsibility is taken for any error, omission or misstatement. This plan is for illustrative purposes only and should be used as such by any prospective purchaser. The services, systems and appliances shown have not been tested and no guarantee as to their operability or efficiency can be given.  
Made with Metropix 13/22

## Area Map

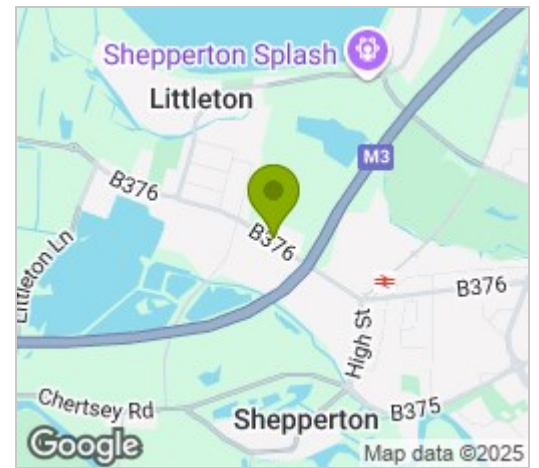

## Energy Efficiency Graph

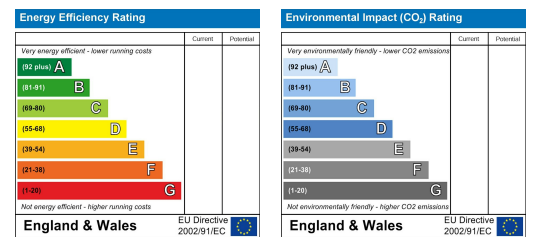

These particulars, whilst believed to be accurate are set out as a general outline only for guidance and do not constitute any part of an offer or contract. Intending purchasers should not rely on them as statements of representation of fact, but must satisfy themselves by inspection or otherwise as to their accuracy. No person in this firm's employment has the authority to make or give any representation or warranty in respect of the property.

**4 Station Approach, Shepperton, Middlesex, TW17 8AR**  
**Tel: 01932232927 Email: sales@newboulds.com www.newboulds.com**